

Lancaster City Council

Application for a premises licence to be granted

under the Licensing Act 2003

PLEASE READ THE FOLLOWING INSTRUCTIONS FIRST

Before completing this form please read the guidance notes at the end of the form. If you are completing this form by hand please write legibly in block capitals. In all cases ensure that your answers are inside the boxes and written in black ink. Use additional sheets if necessary.

You may wish to keep a copy of the completed form for your records.

We Nali's Offy Limited

(Insert name(s) of applicant)

apply for a premises licence under section 17 of the Licensing Act 2003 for the premises described in Part 1 below (the premises) and I/we are making this application to you as the relevant licensing authority in accordance with section 12 of the Licensing Act 2003

Part 1 – Premises Details

Postal address of premises or, if none, ordnance survey map reference or description 77 North Road			
Post town	Lancaster	Postcode	LA1 1LU

Telephone number at premises (if any)	
Non-domestic rateable value of premises	£5,300

Part 2 - Applicant Details

Please state whether you are applying for a premises licence as

Please tick as appropriate

- | | |
|--|---|
| a) an individual or individuals * | <input type="checkbox"/> please complete section (A) |
| b) a person other than an individual * | |
| i. as a limited company | <input checked="" type="checkbox"/> please complete section (B) |
| ii. as a partnership | <input type="checkbox"/> please complete section (B) |

- iii. as an unincorporated association or ☐ please complete section (B)
- iv. other (for example a statutory corporation) ☐ please complete section (B)
- c) a recognised club ☐ please complete section (B)
- d) a charity ☐ please complete section (B)
- e) the proprietor of an educational establishment ☐ please complete section (B)
- f) a health service body ☐ please complete section (B)
- g) a person who is registered under Part 2 of the Care Standards Act 2000 (c14) in respect of an independent hospital in Wales ☐ please complete section (B)
- ga) a person who is registered under Chapter 2 of Part 1 of the Health and Social Care Act 2008 (within the meaning of that Part) in an independent hospital in England ☐ please complete section (B)
- h) the chief officer of police of a police force in England and Wales ☐ please complete section (B)

* If you are applying as a person described in (a) or (b) please confirm:

Please tick yes

I am carrying on or proposing to carry on a business which involves the use of the premises for licensable activities; or ☐

I am making the application pursuant to a
 statutory function or ☐
 a function discharged by virtue of Her Majesty's prerogative ☐

(A) INDIVIDUAL APPLICANTS (fill in as applicable)

Mr <input type="checkbox"/>	Mrs <input type="checkbox"/>	Miss <input type="checkbox"/>	Ms <input type="checkbox"/>	Other Title (for example, Rev)	
Surname			First names		
I am 18 years old or over				<input type="checkbox"/>	Please tick yes
Current postal address if different from premises address					
Post town				Postcode	
Daytime contact telephone number					
E-mail address (optional)					

SECOND INDIVIDUAL APPLICANT (if applicable)

Mr <input type="checkbox"/>	Mrs <input type="checkbox"/>	Miss <input type="checkbox"/>	Ms <input type="checkbox"/>	Other Title (for example, Rev)	
Surname			First names		
I am 18 years old or over				<input type="checkbox"/>	Please tick yes
Current postal address if different from premises address					
Post town				Postcode	
Daytime contact telephone number					
E-mail address (optional)					

(B) OTHER APPLICANTS

Please provide name and registered address of applicant in full. Where appropriate please give any registered number. In the case of a partnership or other joint venture (other than a body corporate), please give the name and address of each party concerned.

Name: Nali's Offy Ltd	
Address: 77 North Road, Lancaster, LA1 1LU	
Registered number (where applicable) 16520137	
Description of applicant (for example, partnership, company, unincorporated association etc.) Limited Company	
Telephone number (if any)	
E-mail address (optional)	

Part 3 Operating Schedule

When do you want the premises licence to start?

DD	MM	YYYY
<input type="text"/>	<input type="text"/>	<input type="text"/>

If you wish the licence to be valid only for a limited period, when do you want it to end?

DD	MM	YYYY
<input type="text"/>	<input type="text"/>	<input type="text"/>

<div></div>

If 5,000 or more people are expected to attend the premises at any one time, please state the number expected to attend.

What licensable activities do you intend to carry on from the premises?

(Please see sections 1 and 14 of the Licensing Act 2003 and Schedules 1 and 2 to the Licensing Act 2003)

Provision of regulated entertainment

Please tick any that apply

- | | |
|---|--------------------------|
| a) plays (if ticking yes, fill in box A) | <input type="checkbox"/> |
| b) films (if ticking yes, fill in box B) | <input type="checkbox"/> |
| c) indoor sporting events (if ticking yes, fill in box C) | <input type="checkbox"/> |
| d) boxing or wrestling entertainment (if ticking yes, fill in box D) | <input type="checkbox"/> |
| e) live music (if ticking yes, fill in box E) | <input type="checkbox"/> |
| f) recorded music (if ticking yes, fill in box F) | <input type="checkbox"/> |
| g) performances of dance (if ticking yes, fill in box G) | <input type="checkbox"/> |
| h) anything of a similar description to that falling within (e), (f) or (g) (if ticking yes, fill in box H) | <input type="checkbox"/> |

Provision of late night refreshment (if ticking yes, fill in box I) ☐

Supply of alcohol (if ticking yes, fill in box J) ☒

In all cases complete boxes K, L and M

A

Plays Standard days and timings (please read guidance note 6)			<u>Will the performance of a play take place indoors or outdoors or both – please tick</u> (please read guidance note 2)	Indoors	<input type="checkbox"/>
				Outdoors	<input type="checkbox"/>
				Both	<input type="checkbox"/>
Day	Start	Finish	<u>Please give further details here</u> (please read guidance note 3)		
Mon					
Tue					
Wed			<u>State any seasonal variations for performing plays</u> (please read guidance note 4)		
Thur					
Fri					
Sat			<u>Non standard timings. Where you intend to use the premises for the performance of plays at different times to those listed in the column on the left, please list</u> (please read guidance note 5)		
Sun					

B

Films Standard days and timings (please read guidance note 6)			<u>Will the exhibition of films take place indoors or outdoors or both – please tick</u> (please read guidance note 2)	Indoors	<input type="checkbox"/>
				Outdoors	<input type="checkbox"/>
				Both	<input type="checkbox"/>
Day	Start	Finish	<u>Please give further details here</u> (please read guidance note 3)		
Mon					
Tue					
Wed					
Thur			<u>State any seasonal variations for the exhibition of films</u> (please read guidance note 4)		
Fri					
Sat					
Sun					
			<u>Non standard timings. Where you intend to use the premises for the exhibition of films at different times to those listed in the column on the left, please list</u> (please read guidance note 5)		

C

Indoor sporting events Standard days and timings (please read guidance note 6)			<u>Please give further details</u> (please read guidance note 3)
Day	Start	Finish	
Mon			
Tue			<u>State any seasonal variations for indoor sporting events</u> (please read guidance note 4)
Wed			
Thur			
Fri			<u>Non standard timings. Where you intend to use the premises for indoor sporting events at different times to those listed in the column on the left, please list</u> (please read guidance note 5)
Sat			
Sun			

D

Boxing or wrestling entertainments Standard days and timings (please read guidance note 6)			<u>Will the boxing or wrestling entertainment take place indoors or outdoors or both – please tick</u> (please read guidance note 2)	Indoors	<input type="checkbox"/>
				Outdoors	<input type="checkbox"/>
				Both	<input type="checkbox"/>
Day	Start	Finish	<u>Please give further details here</u> (please read guidance note 3)		
Mon					
Tue			<u>State any seasonal variations for boxing or wrestling entertainment</u> (please read guidance note 4)		
Wed					
Thur			<u>Non standard timings. Where you intend to use the premises for boxing or wrestling entertainment at different times to those listed in the column on the left, please list</u> (please read guidance note 5)		
Fri					
Sat					
Sun					

E

Live music Standard days and timings (please read guidance note 6)			Will the performance of live music take place indoors or outdoors or both – please tick (please read guidance note 2)		Indoors	<input type="checkbox"/>
					Outdoors	<input type="checkbox"/>
					Both	<input type="checkbox"/>
Day	Start	Finish	Please give further details here (please read guidance note 3)			
Mon						
Tue						
Wed			State any seasonal variations for the performance of live music (please read guidance note 4)			
Thur						
Fri						
Sat			Non standard timings. Where you intend to use the premises for the performance of live music at different times to those listed in the column on the left, please list (please read guidance note 5)			
Sun						

F

Recorded music Standard days and timings (please read guidance note 6)			<u>Will the playing of recorded music take place indoors or outdoors or both – please tick</u> (please read guidance note 2)	Indoors	<input type="checkbox"/>
				Outdoors	<input type="checkbox"/>
				Both	<input type="checkbox"/>
Day	Start	Finish			
Mon			<u>Please give further details here</u> (please read guidance note 3)		
Tue					
Wed			<u>State any seasonal variations for the playing of recorded music</u> (please read guidance note 4)		
Thur					
Fri			<u>Non standard timings. Where you intend to use the premises for the playing of recorded music at different times to those listed in the column on the left, please list</u> (please read guidance note 5)		
Sat					
Sun					

G

Performances of dance Standard days and timings (please read guidance note 6)			<u>Will the performance of dance take place indoors or outdoors or both – please tick</u> (please read guidance note 2)		Indoors	<input type="checkbox"/>
					Outdoors	<input type="checkbox"/>
					Both	<input type="checkbox"/>
Day	Start	Finish	<u>Please give further details here</u> (please read guidance note 3)			
Mon						
Tue						
Wed			<u>State any seasonal variations for the performance of dance</u> (please read guidance note 4)			
Thur						
Fri			<u>Non standard timings. Where you intend to use the premises for the performance of dance at different times to those listed in the column on the left, please list</u> (please read guidance note 5)			
Sat						
Sun						

H

Anything of a similar description to that falling within (e), (f) or (g) Standard days and timings (please read guidance note 6)			Please give a description of the type of entertainment you will be providing		
Day	Start	Finish	<u>Will this entertainment take place indoors or outdoors or both – please tick</u> (please read guidance note 2)	Indoors	<input type="checkbox"/>
Mon				Outdoors	<input type="checkbox"/>
				Both	<input type="checkbox"/>
Tue			<u>Please give further details here</u> (please read guidance note 3)		
Wed					
Thur			<u>State any seasonal variations for entertainment of a similar description to that falling within (e), (f) or (g)</u> (please read guidance note 4)		
Fri					
Sat			<u>Non standard timings. Where you intend to use the premises for the entertainment of a similar description to that falling within (e), (f) or (g) at different times to those listed in the column on the left, please list</u> (please read guidance note 5)		
Sun					





I

Late night refreshment Standard days and timings (please read guidance note 6)			Will the provision of late night refreshment take place indoors or outdoors or both – please tick (please read guidance note 2)		Indoors	<input type="checkbox"/>
					Outdoors	<input type="checkbox"/>
					Both	<input type="checkbox"/>
Day	Start	Finish				
Mon			<u>Please give further details here</u> (please read guidance note 3)			
Tue						
Wed			<u>State any seasonal variations for the provision of late night refreshment</u> (please read guidance note 4)			
Thur						
Fri			<u>Non standard timings. Where you intend to use the premises for the provision of late night refreshment at different times, to those listed in the column on the left, please list</u> (please read guidance note 5)			
Sat						
Sun						

J

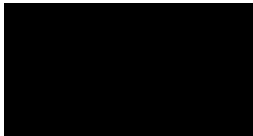
Supply of alcohol Standard days and timings (please read guidance note 6)			<u>Will the supply of alcohol be for consumption – please tick</u> (please read guidance note 7)	On the premises	
				Off the premises	<input checked="" type="checkbox"/>
				Both	<input type="checkbox"/>
Day	Start	Finish	<u>State any seasonal variations for the supply of alcohol</u> (please read guidance note 4) No seasonal variations		
Mon	08.00	02.00			
Tue	08.00	02.00			
Wed	08.00	02.00			
Thur	08.00	02.00			
			<u>Non standard timings. Where you intend to use the premises for the supply of alcohol at different times to those listed in the column on the left, please list</u> (please read guidance note 5) None		
Fri	08.00	02.00			
Sat	08.00	02.00			
Sun	08.00	02.00			

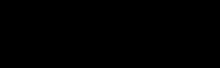
State the name and details of the individual whom you wish to specify on the licence as designated premises supervisor:

Name Annamaria Fece	
	
Postcode	
Personal licence number (if known)	
Issuing licensing authority (if known)	

K

Please highlight any adult entertainment or services, activities, other entertainment or matters ancillary to the use of the premises that may give rise to concern in respect of children (please read guidance note 8).

No adult entertainment or activities on the premises

L

Hours premises are open to the public Standard days and timings (please read guidance note 6)			<u>State any seasonal variations</u> (please read guidance note 4) No Seasonal variations
Day	Start	Finish	<u>Non standard timings. Where you intend the premises to be open to the public at different times from those listed in the column on the left, please list</u> (please read guidance note 5) Not applicable
Mon	08.00	02.00	
Tue	08.00	02.00	
Wed	08.00	02.00	
Thur	08.00	02.00	
Fri	08.00	02.00	
Sat	08.00	02.00	
Sun	08.00	02.00	

M Describe the steps you intend to take to promote the four licensing objectives:

a) General – all four licensing objectives (b, c, d and e) (please read guidance note 9)

See attached conditions of licence

b) The prevention of crime and disorder

See attached conditions of licence

c) Public safety

See attached conditions of licence

d) The prevention of public nuisance

- See attached conditions of licence

e) The protection of children from harm

See attached conditions of licence

Checklist:

Please tick to indicate agreement

- I have made or enclosed payment of the fee. ☒
- I have enclosed the plan of the premises. ☒
- I have sent copies of this application and the plan to responsible authorities and others where applicable. ☒
- I have enclosed the consent form completed by the individual I wish to be designated premises supervisor, if applicable. ☒
- I understand that I must now advertise my application. ☒

- I understand that if I do not comply with the above requirements my application will be rejected. ☒

IT IS AN OFFENCE, LIABLE ON SUMMARY CONVICTION TO A FINE NOT EXCEEDING LEVEL 5 ON THE STANDARD SCALE, UNDER SECTION 158 OF THE LICENSING ACT 2003, TO MAKE A FALSE STATEMENT IN OR IN CONNECTION WITH THIS APPLICATION.

IT IS AN OFFENCE UNDER SECTION 24B OF THE IMMIGRATION ACT 1971 FOR A PERSON TO WORK WHEN THEY KNOW, OR HAVE REASONABLE CAUSE TO BELIEVE, THAT THEY ARE DISQUALIFIED FROM DOING SO BY REASON OF THEIR IMMIGRATION STATUS. THOSE WHO EMPLOY AN ADULT WITHOUT LEAVE OR WHO IS SUBJECT TO CONDITIONS AS TO EMPLOYMENT WILL BE LIABLE TO A CIVIL PENALTY UNDER SECTION 15 OF THE IMMIGRATION, ASYLUM AND NATIONALITY ACT 2006 AND PURSUANT TO SECTION 21 OF THE SAME ACT, WILL BE COMMITTING AN OFFENCE WHERE THEY DO SO IN THE KNOWLEDGE, OR WITH REASONABLE CAUSE TO BELIEVE, THAT THE EMPLOYEE IS DISQUALIFIED

I confirm that I am entitled to work in the UK and I am not subject to conditions preventing me from doing work relating to a licensable activity. I enclose a copy of my proof of entitlement to work.

I understand I am not entitled to be issued with a licence if I do not have the entitlement to live and work in the UK (or if I am subject to a condition preventing me from doing work relating to the carrying on of a licensable activity) and that my licence will become invalid if I cease to be entitled to live and work in the UK

Part 4 – Signatures (please read guidance note 10)

**Signature of applicant or applicant's solicitor or other duly authorised agent (see guidance note 11).
If signing on behalf of the applicant, please state in what capacity.**

Signature		
-----------	--	--

Date	19/8/25
Capacity	Director

For joint applications, signature of 2nd applicant or 2nd applicant's solicitor or other authorised agent (please read guidance note 12). If signing on behalf of the applicant, please state in what capacity.

Signature	
Date	
Capacity	

Contact name (where not previously given) and postal address for correspondence associated with this application (please read guidance note 13)			
Post town		Postcode	
Telephone number (if any)			
If you would prefer us to correspond with you by e-mail, your e-mail address (optional)			

Notes for Guidance

1. Describe the premises, for example the type of premises, its general situation and layout and any other information which could be relevant to the licensing objectives. Where your application includes off-supplies of alcohol and you intend to provide a place for consumption of these off-supplies, you must include a description of where the place will be and its proximity to the premises.
2. Where taking place in a building or other structure please tick as appropriate (indoors may include a tent).
3. For example the type of activity to be authorised, if not already stated, and give relevant further details, for example (but not exclusively) whether or not music will be amplified or unamplified.
4. For example (but not exclusively), where the activity will occur on additional days during the summer months.
5. For example (but not exclusively), where you wish the activity to go on longer on a particular day e.g. Christmas Eve.
6. Please give timings in 24 hour clock (e.g. 16:00) and only give details for the days of the week when you intend the premises to be used for the activity.
7. If you wish people to be able to consume alcohol on the premises, please tick 'on the premises'. If you wish people to be able to purchase alcohol to consume away from the premises, please tick 'off the premises'. If you wish people to be able to do both, please tick 'both'.
8. Please give information about anything intended to occur at the premises or ancillary to the use of the premises which may give rise to concern in respect of children, regardless of whether you

intend children to have access to the premises, for example (but not exclusively) nudity or semi-nudity, films for restricted age groups or the presence of gaming machines.

9. Please list here steps you will take to promote all four licensing objectives together.
10. The application form must be signed.
11. An applicant's agent (for example solicitor) may sign the form on their behalf provided that they have actual authority to do so.
12. Where there is more than one applicant, each of the applicant or their respective agent must sign the application form.
13. This is the address which we shall use to correspond with you about this application.

NALI'S OFFY, 77 NORTH ROAD LANCASTER

Police Conditions:

A documented Challenge 25 scheme will be operated at the premises. The Challenge 25 scheme shall be actively promoted and advertised at the premises and will ensure that any person purchasing alcohol, who appears to be under 25 years of age, shall be asked to provide acceptable identification to prove that they are 18 years of age or over. Failure to supply such identification will result in no sale or supply of alcohol to that person.

The Proof of Age Standards Scheme (PASS) will be actively promoted at the premises by the display of Challenge 25 posters bearing the PASS logo.

A PASS accredited holographic proof of age card will be the main identification document accepted at the premises as proof of age. A PASS card must be accepted as proof of age if a purchaser possesses one. Where a purchaser does not possess a PASS accredited proof of age card, only the following alternative forms of alternative identification will be acceptable:-

- a) PASS-approved, proof of age card
- b) UK photographic driving licence
- c) Citizen card supported by the Home Office
- d) Official ID card issued by HM Forces
- e) Passport
- f) Any electronic or biometric age verification technology approved by the Government

To utilise and fully record any refused sales or challenges made to patrons and such records be kept in an appropriate form and be made available on inspection to the police or other authorised agency.

All staff involved with the provision of alcohol will successfully complete training in age related products prior to operating a till. Refresher training will also be successfully completed not more than every 6 months; this will be fully documented and be available for inspection to police officers or other authorised persons.

CCTV equipment shall be installed and be maintained in good working order in accordance with the manufacturer's instructions. Training should be provided for staff members in the usage of the CCTV equipment. CCTV footage recorded must, as a minimum, cover each entry/exit point of the premises and be recording at all times when the premises is conducting licensable activities. The system will display on any recording the correct time and date of the recording. The images captured must be of a suitable standard required by Lancashire Constabulary.

The images recorded by the CCTV system shall be retained in unedited form for a period of not less than 30 days. A staff member who is conversant with

the operation of the CCTV system will be on the premises at all times that the premises are open to the public. This staff member will be able to show police or any other authorised person recent data or footage with the absolute minimum of delay, when requested.

The Data Controller will make footage available within a reasonable time to a Police Constable or any other Authorised Officer, where such request is made in accordance with and which satisfies the Data Protection Act 1998.

A system of till prompts for all age related products will be installed at the premises and will be used during all transactions

No member of the public permitted access inside the shop after 11pm daily.

All sales after 11pm (whether alcohol or otherwise) are to be made via a window hatch until premises closes at 2am.

No single can sales of alcohol to be made to the public at any time.

Conditions relating to deliveries/phone /internet sales:

The premises website homepage shall clearly state alcohol sales shall only be made to persons aged 18 and over and the 'Challenge 25' policy promoted.

Deliveries must only take place within the permitted licensed hours and not outside these hours.

Payment must not be taken at the property where the order is being delivered to ie no cash transactions 'at the door' or direct sales from the delivery vehicle must take place.

Payment must be made, by card (debit or credit) when placing the order, in advance of delivery. At this point, details should be taken and a copy of all sales logged including the age verification measures taken at the time of each sale. Also, verification that an age check was carried out at the time of delivery and suitable ID shown.

For deliveries made by courier services/3rd party delivery, deliveries must still be signed for by a person over the age of 18.

All deliveries must be accepted by an individual ie not left in safe place or unsigned for.

All deliveries of alcohol shall be delivered to a premises address with a valid postcode ie not just to a street corner or public space

A record of all transactions will be maintained. The transaction record will contain the name, address, details of the order, requested time of order. This

shall be documented and available for inspection to Police Officers or other authorised persons.

During the operating premises times of the premises licence, the delivery vehicle shall only contain items which have been pre-ordered, purchased and selected for the documented customers. No surplus/additional stock to be conveyed in the delivery vehicle at any time.

No alcohol will be delivered to any person intoxicated.

Delivery drivers shall be instructed to enter and leave their vehicles quietly and considerately, not to leave engines running, to park considerately, and at all time to have in mind the neighbours and in particular residential occupiers.

Additional Conditions:

Delivery drivers must not park on the taxi rank on North Road in Lancaster. Drivers of the delivery vehicles will be informed of this requirement prior to employment or undertaking deliveries on the premises behalf, regular reminders will be provided.

No music shall be played at the premises at any time.

Licensable area

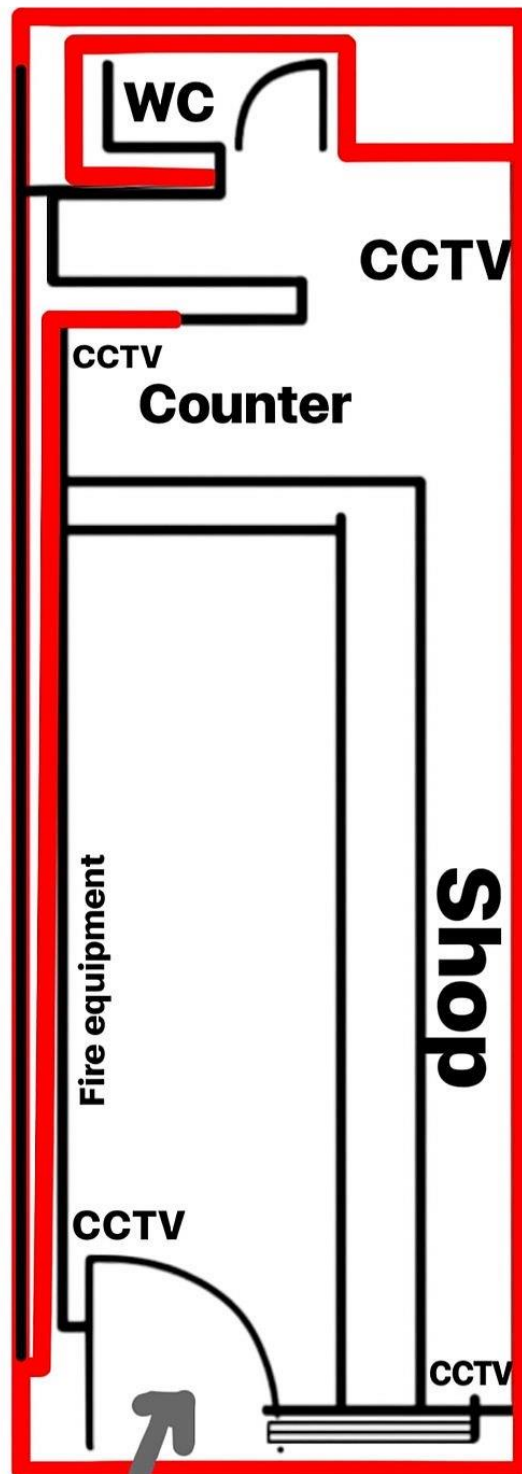

77 north road