

.....

VENUE GUIDE

.....

THE
BOY

LANCASTER
CITY COUNCIL

Promoting City, Coast & Countryside

*Where
cultural
heritage*

MEETS

**[21st CENTURY
CREATIVE
INDUSTRY]**



This prestigious Grade II listed building was constructed between 1887 and 1891 to commemorate Queen Victoria's Golden Jubilee. Thomas Storey provided the funding for the building which was renamed the Storey Institute in his honour in 1891.

Its purpose was for 'the promotion of art, science, literature, and technical instruction'. Its first art exhibition, held in 1889, included paintings by Gainsborough, Constable, and Canaletto.

The Storey is one of the most recognisable buildings in the city and is a gateway to the town centre. It also acts as the gateway to Castle Hill and the medieval Lancaster Castle and is only a minute's walk from Lancaster Train Station.

Lancaster is conveniently located on the West Coast Main Line from London to Glasgow.

.....
AMAZING
SPACES FOR
INNOVATION,
SPECIAL
OCCASIONS &
CORPORATE
EVENTS
.....

THE
STOREY

LANCASTER
CITY COUNCIL

Promoting City, Coast & Countryside



.....
 BE PART
 OF THE
 STOREY &
 SHARE OUR
 SPACE...

FOR ROOM HIRE CONTACT:

01524 582392

roombookings@lancaster.gov.uk

For prices visit

www.thestorey.co.uk

.....

The Storey is currently home to creative industries ranging from graphic design to film and media production.

As well as welcoming creative industry, the building plays host to an exciting array of literary performances, workshops, art exhibitions and film, music and theatrical recitals. Event planners have chosen The Storey to host their business conferences, seminars and networking events.

The Storey is prominent in Lancaster's history and is looking forward to being a big part of its future.

If you are hosting an event at The Storey we can help you sell tickets through the Visitor Information Centre and via our on-line shop www.lancaster.gov.uk/VICTicketbox - for more details contact: (01524) 582394 or lancastervic@lancaster.gov.uk

.....

THE
 STOREY

LANCASTER
 CITY COUNCIL

Promoting City, Coast & Countryside



MUSIC ROOM

TECH SPEC:

Lighting: 20 x adjustable lighting system (without dimmer switch)

Disabled access

Wireless access

The room can be booked in conjunction with the Gallery to provide a superb space accommodating up to 200 people

Wall plated system for hanging and mounting.

A room of grandeur and steeped in history as it was once part of the city art gallery. The Music Room still retains beautiful original architecture and is a stunning backdrop for corporate events and weddings seating up to 70 people or meetings up to 100.



THE STOREY

LANCASTER
CITY COUNCIL

Promoting City, Coast & Countryside

LECTURE THEATRE



TECH SPEC:

Surround sound amplifier
wall mounted speakers

Projector
Electric folding projector
screen (1.8m x 2.4m)
Dvd player with remote control
Laptop

Disabled access
Wireless access

This 75 seated lecture theatre with audio visual equipment also has extremely good acoustics and can be blacked out if required. It is an ideal venue for presentations, helping to create an engaging experience for your audience. With fixed tiered seating it is an ideal venue for presentations, product launches, AGMs, screenings, press conferences and road shows.

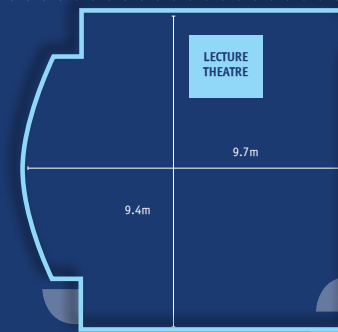

THE STOREY

**LANCASTER
CITY COUNCIL**
Promoting City, Coast & Countryside



AUDITORIUM

TECH SPEC:

Mobile stage: 7 x 2.44m by 1.22m
 Top deck sections
 2 x 1.22m by 1.22m
 4 x 0.33m legs

House lighting without
 dimmer switch: Lighting desk

DMX Dimmers
 2 x CCT Profile Minuette 21 ⇔ 36
 8 x CCT Minuette FR 18 ⇔ 57
 10 x Euro Light ML64 GKV multi
 lens spot light + Assorted Barn
 Door fittings and Gel holders
 4 x Minuette 500w flood light

PA system:
 Mobile PA rack with sound desk,
 tape deck and mini disc player
 Speakers (fixed position)
 Projector & screen (2.05m x
 2.75m)

Speakers: (fixed positions)
 4 x FBT Verve 8MA process active
 frequency monitor speakers
 8 x 8 Channel multi-core + 4
 returns
 4 x XLR Leads
 1 x Di20 Distro splitter box

Disabled access
 Wireless access
 Induction loop

Step into the 21st Century with state of the art audio and visual technology suitable for a wide range of events.

The acoustics in this room are perfect for presentations, fashion shows, theatrical productions and open mic events. The lighting system enhances your event and creates the perfect ambience for the audience with a standing capacity of 150 and a seated capacity of 80.

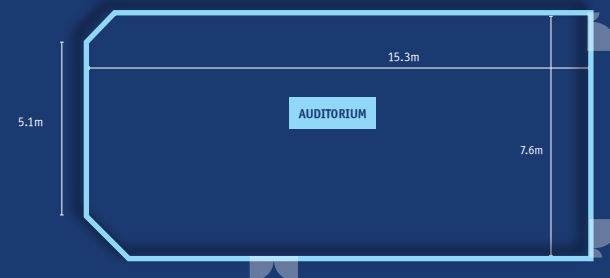

THE STOREY

LANCASTER
CITY COUNCIL
Promoting City, Coast & Countryside



THE GALLERY

TECH SPEC:

Lighting 28 x Adjustable gallery lighting system with dimmer switch.

Wall plated system for hanging and mounting

Access from the rear of the building for loading large equipment

Temperature control/heating

Disabled access

Wireless access

Natural polished wooden floor

Situated on the first floor this amazing space is flooded with natural light and is top-lit by a lantern spanned by 4 trusses. In a semicircular alcove at the rear is a marble statue of Queen Victoria and the Prince Consort sculpted by Mr Wood of Chelsea. The Gallery can cater for Exhibitions and Weddings for up to 150 people.

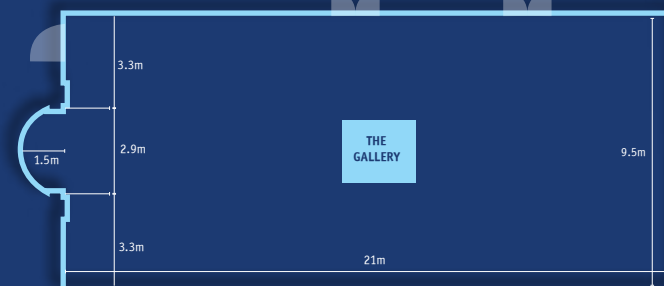

THE STOREY

LANCASTER
CITY COUNCIL

Promoting City, Coast & Countryside

MEETING ROOMS



The Reading Room & Writing Room

A large elegant modern space perfect for meetings, presentations or training with space for up to 50 delegates in theatre style or 30 in cabaret style seating.

The Drawing Room

A small intimate and informal space for meetings, presentations, focus group space or training. The room has a capacity for 10 people seated.

Both rooms have disabled access and wireless access.

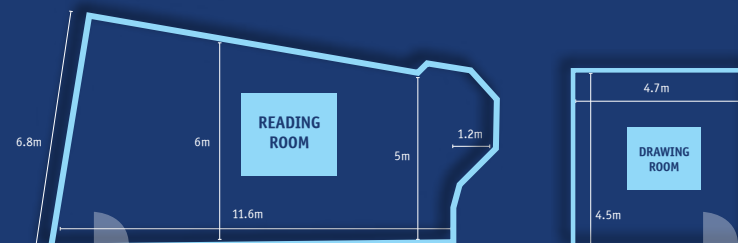

THE STOREY

LANCASTER CITY COUNCIL
Promoting City, Coast & Countryside

WORK SPACES



TECH SPEC:
Shower and kitchen facilities
24 hour access

Discounts on additional
room bookings

'Superfast' broadband available

No two workspaces in the Storey are the same. We offer blank canvases for creative people. We won't tell you where your desk should be, or even if you should have a desk but we will provide you with all you need to plug in switch on and be creative including fast internet connection, a staffed reception, security and lifts.

The architects have sympathetically woven contemporary design and function into the historic fabric.

If you are involved in the creative sector and are looking for the perfect space to set up – talk to us:

Property Services,
Lancaster City Council

T: 01524 582967

E: property@lancaster.gov.uk

THE STOREY

**LANCASTER
CITY COUNCIL**
Promoting City, Coast & Countryside



By Car:

FROM THE NORTH: M6 Junction 34 and A683 into Lancaster on Caton Road. When you join the one-way system stay in the left lane through three sets of traffic lights, then switch to the right lane. This will take you past the Town Hall traffic lights. 300 yards later the lane will turn a tight right bend through another set of lights and you are on King Street. As you approach KFC take the left lane, turning left at the traffic lights next to Waterstones Bookshop. The first turn right is for Castle Hill and The Storey is on the corner. A limited amount of parking is available on Castle Hill. Dallas Road car park is nearby for longer stays. Coach Parking is on Edward Street, on the opposite side of the Town centre.

FROM THE SOUTH: M6 junction 33 and A6 into the centre of Lancaster, turning left at Waterstones Bookshop and next right onto Castle Hill. The Storey is on the corner. A limited amount of parking is available on Castle Hill. Dallas Road car park is nearby for longer stays. Coach Parking is on Edward Street, on the opposite side of the Town centre.

The Storey is 0.2 miles from Lancaster train station which is on the West Coast Main Line

Journey Times

| Location | Train * | Car ** |
|------------|---------------|---------------|
| London | 2 hrs 34 mins | 4 hrs 29 mins |
| Edinburgh | 2 hrs 10 mins | 3 hrs 4 mins |
| Glasgow | 1 hr 56 mins | 2 hrs 42 mins |
| Birmingham | 1 hr 48 mins | 2 hrs 20 mins |
| Leeds | 1 hr 52 mins | 1 hr 37 mins |
| Liverpool | 1 hr 33 mins | 1 hr 8 mins |
| Manchester | 54 mins | 1 hr 6 mins |

* From the city centre and based on minimum changes
 ** From the city centre

The Storey, Meeting House Lane, Lancaster, LA1 1TH

In the historic city of Lancaster with views over Morecambe Bay to the Lake District, the Storey is located in one of the most inspiring settings in the North West.

The Storey is situated extremely close to Lancaster train station and is easily accessible via the M6 being a 10min drive (2.8 miles).

FIND US

THE
STOREY

LANCASTER
CITY COUNCIL

Promoting City, Coast & Countryside



The Lancaster Visitor Information Centre is located on the ground floor in The Storey. Whether you require advice on what to do and see in the district, or whether you'd like to find out a little more about the history and heritage of the area or purchase a souvenir, buy theatre and show tickets call in and talk to our friendly and helpful staff.

Make a break and stay in a cottage, hotel or bed and breakfast. Let them book your accommodation for you. The staff have first-hand knowledge of local establishments and can help you find the perfect place.

The team can also sort your travel plans, and book your tickets with Seacat, National Express and Travellers' Choice Coach Excursions.

STAY & EXPLORE

 @morelancaster

 /LancasterMorecambeVICs

OPEN FROM:
Monday to Saturday
from 10 - 4pm

T: 01524 582394
lancastervic@lancaster.gov.uk
www.visitlancaster.org.uk

THE STOREY

**LANCASTER
CITY COUNCIL**
Promoting City, Coast & Countryside

The Storey
Meeting House Lane
Lancaster
LA1 1TH

 @The_Storey

 /thestoreylancaster

THE STOREY

To discuss how we can accommodate you, please get in touch:

FOR OFFICE SPACE:

T: 01524 582967

E: property@lancaster.gov.uk

FOR ROOM HIRE:

T: 01524 582392

E: roombookings@lancaster.gov.uk

For prices visit www.thestorey.co.uk